

sisis[®]

FLEXI 400

INSTRUCTION MANUAL

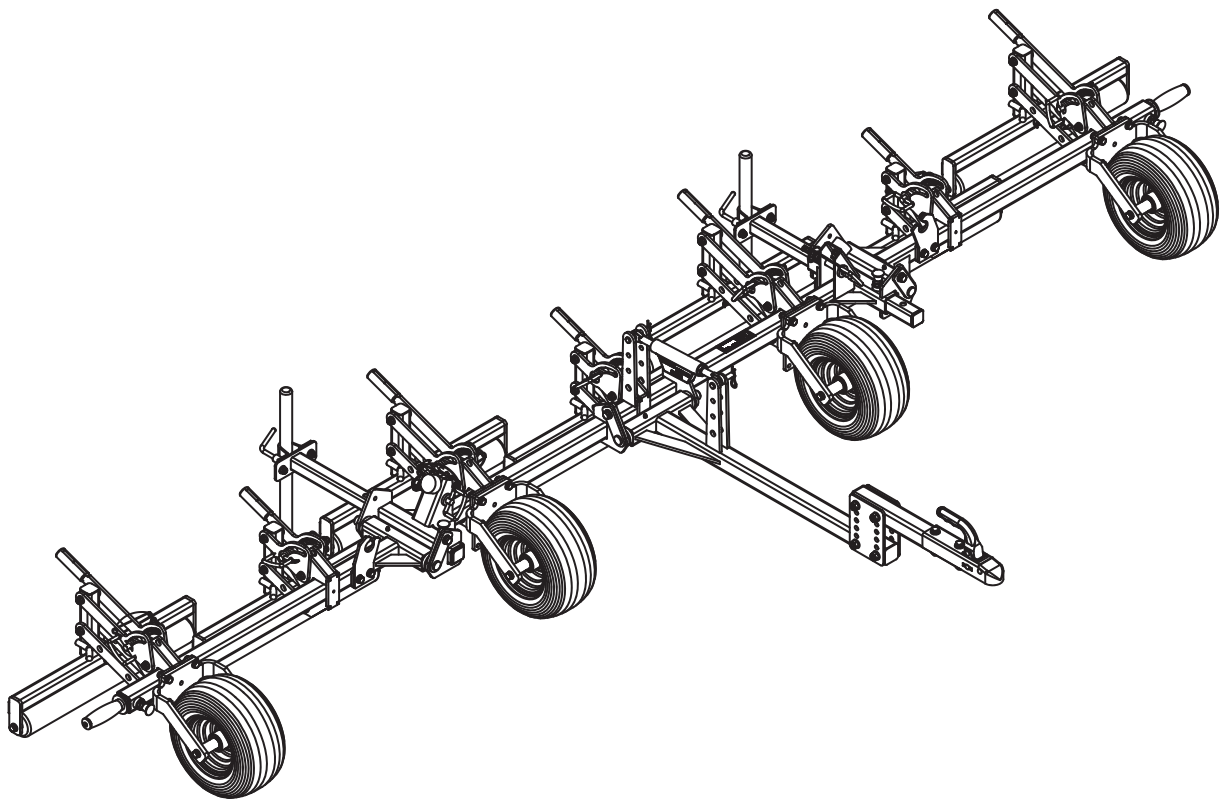

SISIS, Ashbourne Road, Kirk Langley, Derbyshire, DE6 4NJ, England.

Tel: +44 (0) 1332 824 777 | Fax: +44 (0) 1332 824 525 | Email: info@sisis.com | www.sisis.com

A division of Howardson Ltd. - a proudly British company
Company reg no 641526 - Vat No GB 345 9918 12

SP20037_REV_0
02/15



NOTE

MAKE A NOTE OF THE SERIAL NUMBERS OF YOUR MACHINE & ENGINE AND ALWAYS QUOTE THEM IN ANY COMMUNICATION WITH PERSONNEL AT SISIS.

MACHINE SERIAL NUMBER

Introduction

The **SISIS Flexi 400** is virtually maintenance-free, brushes or rollers can be easily replaced should they become worn.

It is advisable to read the instructions carefully. Proper care and attention will enable the machine to give a continuous, satisfactory, and reliable service.

In the case of any difficulty, or if further information or advice is required, our Service Department is always at your call. In the interests of speed and accuracy of information please quote the serial number of the machine when making enquiries.

For the machine, this is to be found on a plate attached to the front of the frame. We suggest you write the numbers above.

Contents

	Page
Serial Numbers.....	2
Introduction.....	2
Technical Data.....	2 - 3
Important Safety Instructions.....	4
Operating Instructions	4 - 7
Parts Listings.....	8 - 17

Technical Data

Model	Flexi 400
Working Width	4000mm (158")
Power Unit Requirement	15Hp min
Weight	200kg
Tyre Pressure	30psi / 2 Bar

WORKING

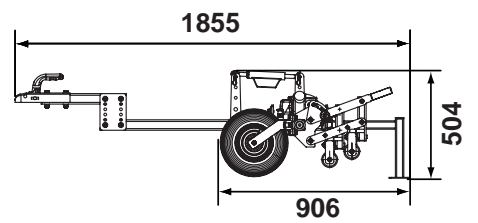
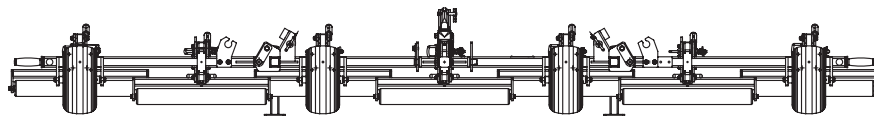
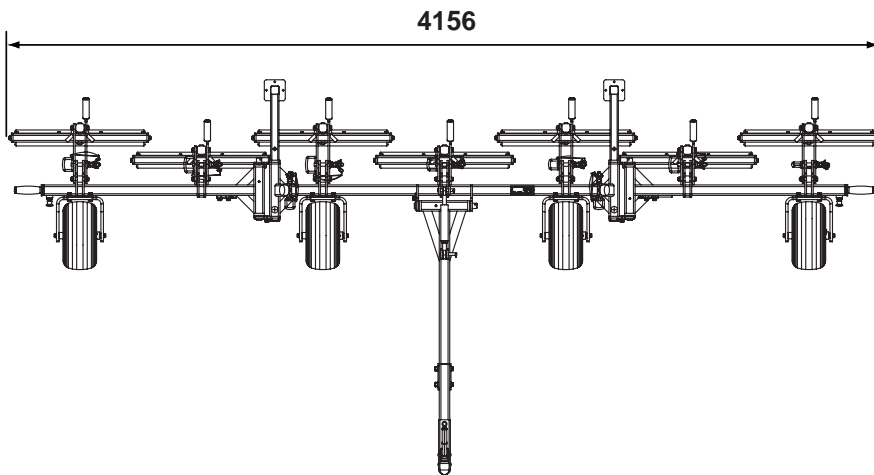

STORED

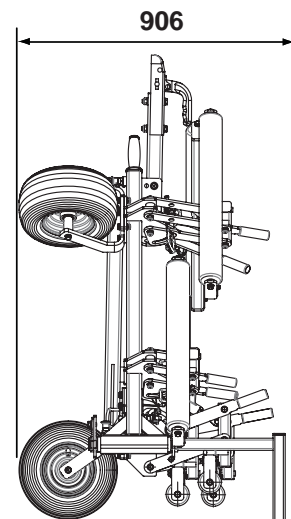
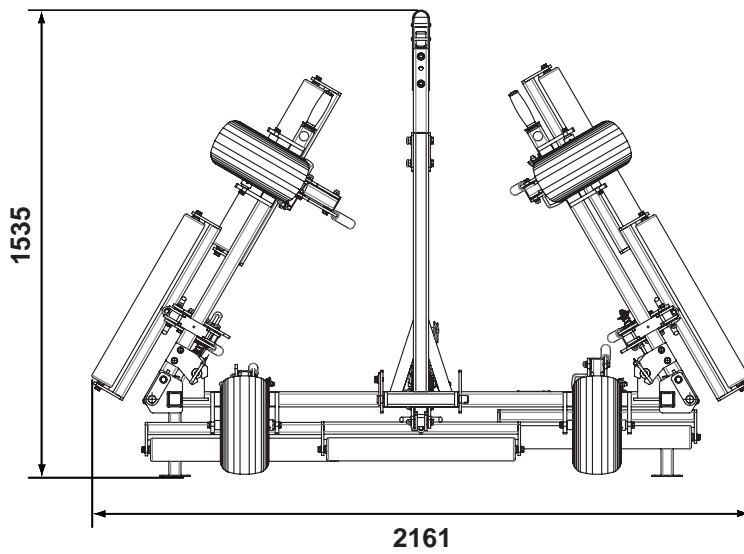
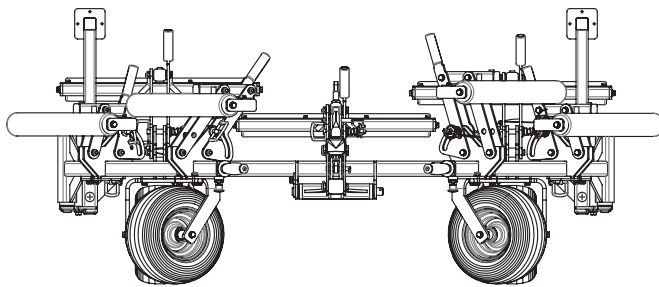

Important Safety Instructions



CAUTION

READ THE INSTRUCTIONS CAREFULLY AND ALSO THE SEPARATE INSTRUCTION DETAILS ON THE ENGINE.

ALWAYS

- Read the operating instructions carefully and understand the controls before commencing work.
- Be extra careful to avoid spillage, when using petrol or diesel fuel. **DANGER** no smoking or naked lights
- Use safety guards and make sure they are correctly in position. They are supplied for your protection
- Visually check machines before starting work for damage or wear to working parts such as blades, tines or loose fasteners
- Respect powered machines. Always keep hands and feet clear of moving parts and remember that tine cylinders or drums can continue to rotate even after the power unit is switched off
- Switch off the power before making adjustments or repairs and never lift or carry a machine whilst any parts are Moving

EYE PROTECTION

In dry, dusty or windy conditions it may be necessary to wear eye protection to protect your eyes from flying debris.

Operating Instructions



CAUTION

PLEASE READ THESE OPERATING INSTRUCTIONS CAREFULLY BEFORE COMMENCING WORK.

We want you to obtain the best performance from this machine. If you have any difficulty in carrying out the following instructions please contact SISIS direct or your local SISIS Territory Manager or SISIS Dealer.

OPERATING PRINCIPAL

The **SISIS Flexi 400** is an interchangeable unit which has been specifically designed for fast and effective coverage on large areas such as golf fairways and sports grounds. The unit has seven fully floating heads which allows it to follow ground contours. Fitted with either rollers or brush heads, it is ideal for the removal of dew, striping for improved presentation, lifting grasses prior to cutting, or brushing in top dressing.

OPERATING INSTRUCTIONS

Height Adjustment

Depending on the towing vehicle, the height of the drawbar may need to be adjusted. This can be achieved in 2 ways, (See **Figure 1a & Figure 1b**). When correctly adjusted, Pin (**F21746**) should be central in the slot. This will give an equal amount of travel up and down on undulating surfaces (**Figure 1c**)

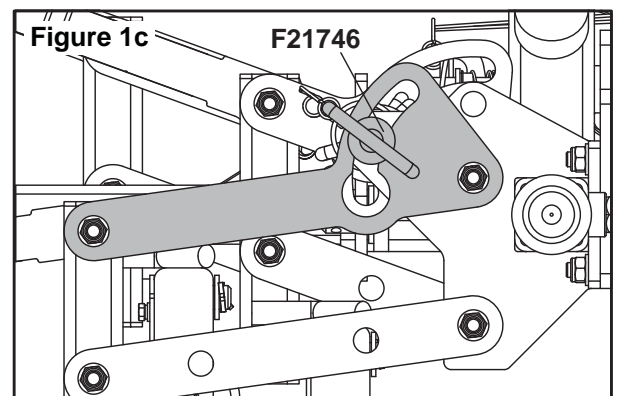
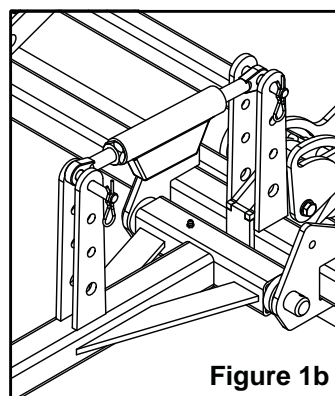
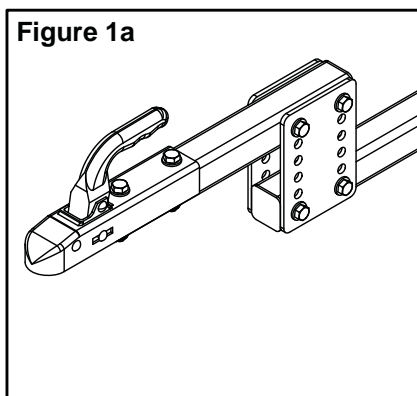

Support Legs (Figure 2)

When stored, or not attached to a vehicle, the support legs must be used.

To extend the legs:

- Pull the indexing plunger (F22336) and slide the stand assembly out until the plunger drops into the second hole.
- Slacken the clamp lever on the leg (F20723).
- Lower the leg to level the machine.
- Re-tighten the clamp lever.

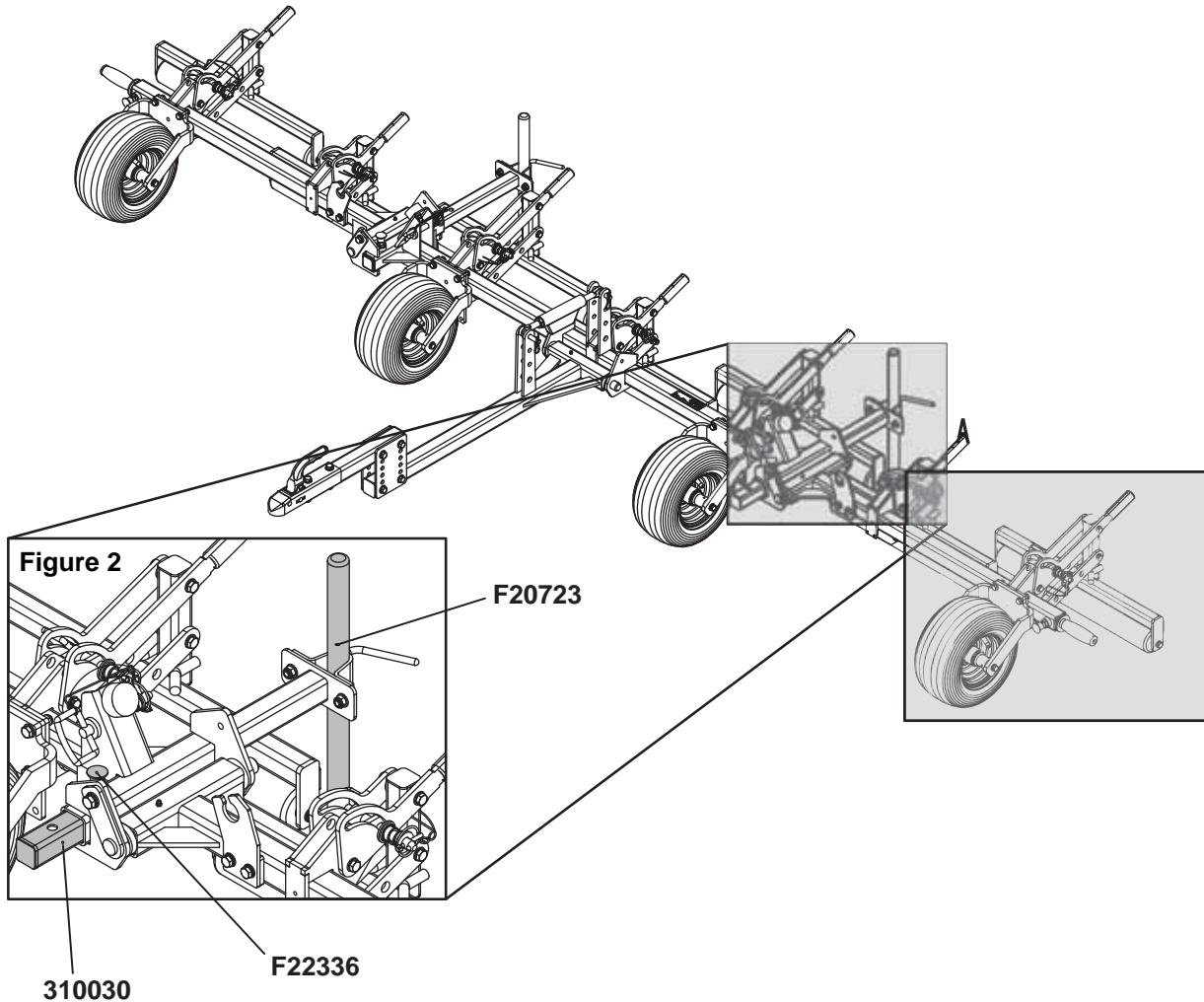

Locking individual heads (Figure 3)

For transport and storage the 7-off floating heads must be locked in the up position.

To achieve this, simply lift the lever (310040) until the pin (F21746) clicks into position.

Ensure this is fully engaged.

To release, take the weight of the head by holding the lever (310040). Pull the pin (F21746).

Lower the head to the ground.

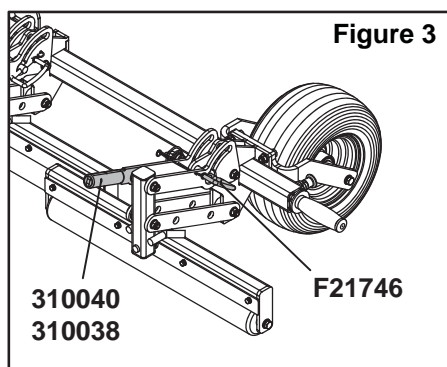

Folding Arms

The arms on the **Flexi 400** can be folded away for transportation and storage.

Figure 4a and **Figure 4b** show that by pulling indexing plunger (**F22336**) an extension arm can be drawn from the unit.

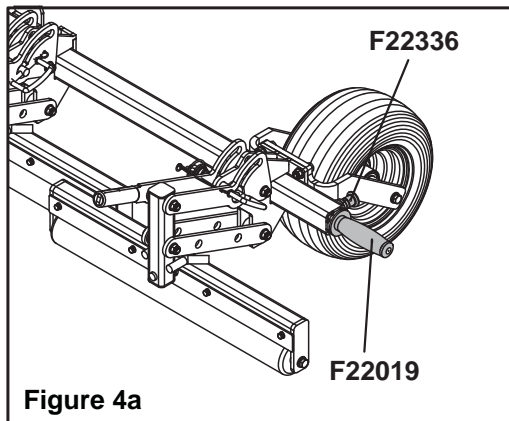

Figure 4a

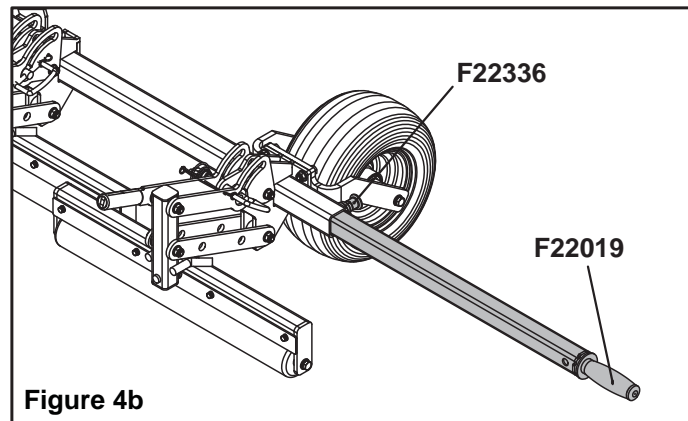

Figure 4b

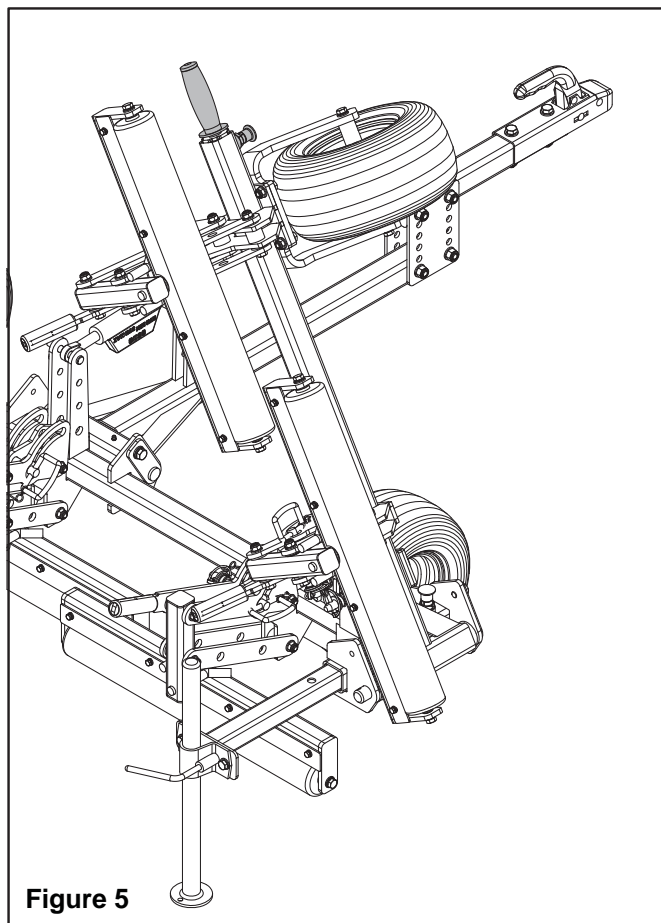

Figure 5

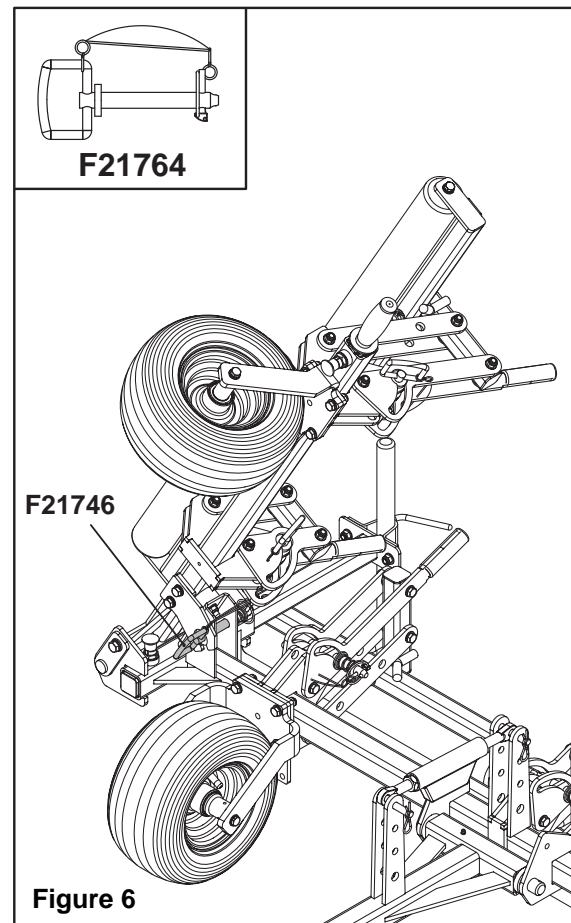

Figure 6

Using handle grip (**F22019**), the arm unit can be lifted to the folded position shown in **Figure 5**. To lock the arm in this position, pull the pin (**F21746**) shown in **Figure 6**.

To unfold the arm, reverse the procedure taking care to lower the arm down. Do not allow the arm to fall.

NOTE:

These arms must be locked in place before transporting.

Never leave the machine unattended with the arms unlocked whilst folded.

Drawbar Storage

To reduce the space required to store the unit, the Drawbar can be stored as per **Figure 7**.

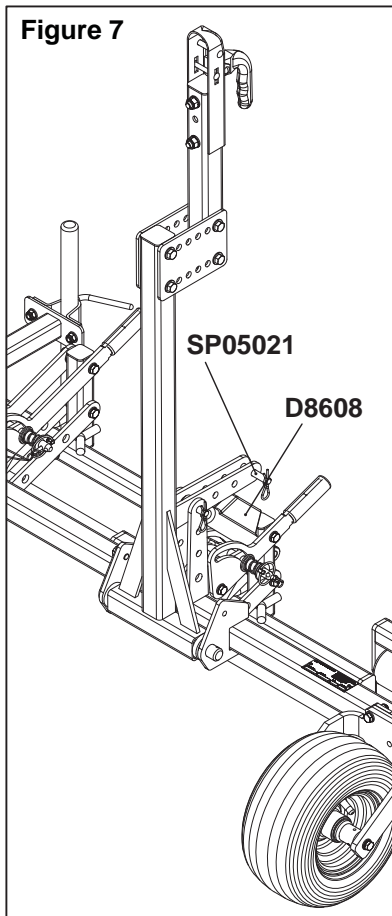
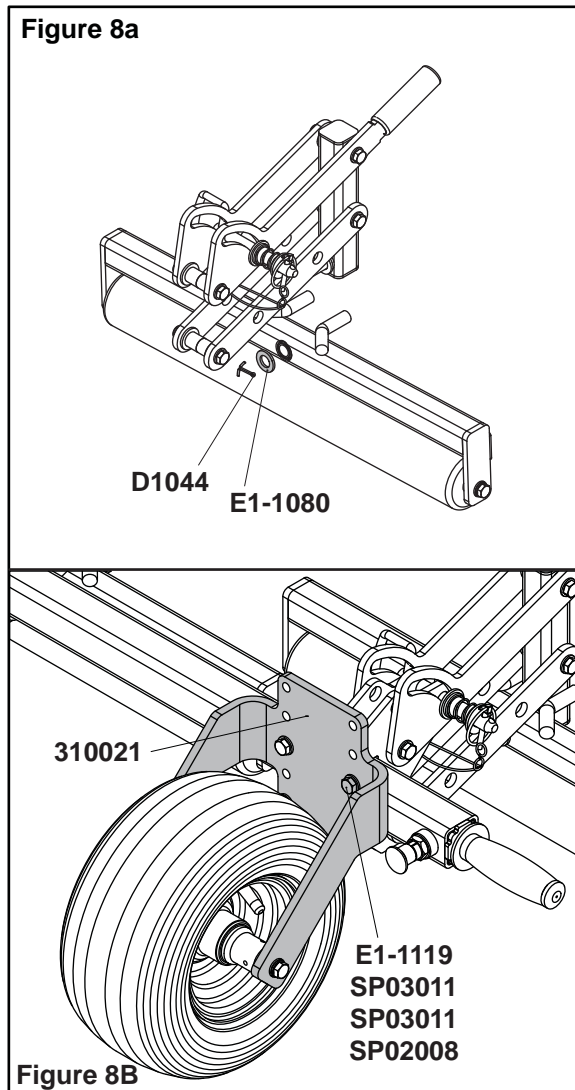

Figure 8a



Changing Heads

To change between a roller head and brush:

- 1) Remove split pin (**D1044**) (See **Figure 8a**)
- 2) Remove Washer (**E1-1080**) (See **Figure 8a**)
- 3) Remove Head (See **Figure 8a**)
- 4) Reverse the procedure to fit alternative head.

There is a height difference between the Brush and the Roller.
When a change is made, the wheel frame will need to be adjusted.

Figure 8b shows 1 of the 4 wheel frames (**310021**) in the roller position.

This must be moved to the lowest position to suit the standard D1520 brush section.

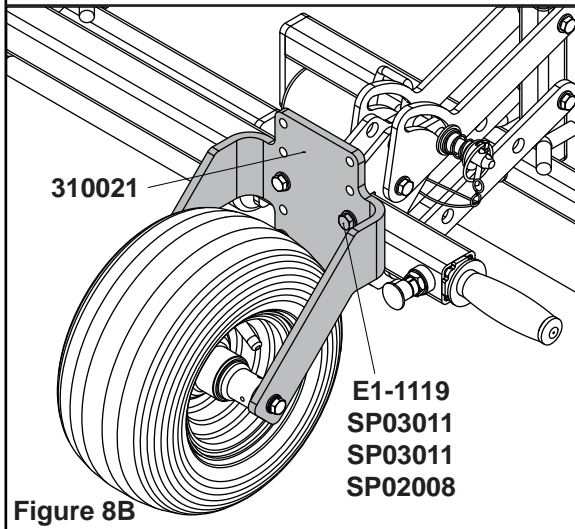
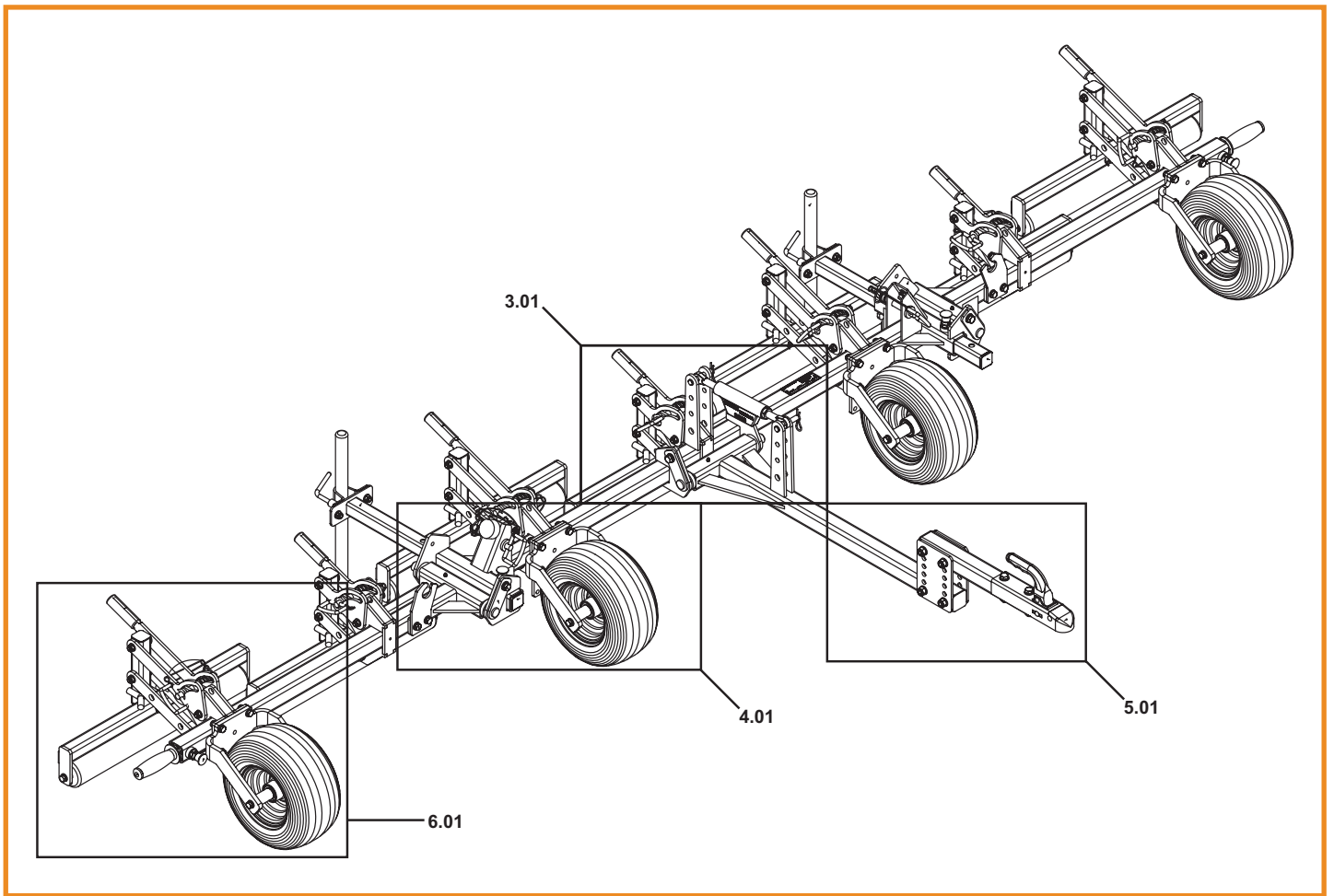

Figure 8B



1.01

Flexi 400_1

Item No.	Part No.	Description	Quantity
3.01	See Page 13		
4.01	See Page 14		
5.01	See Page 15		
6.01	See Page 16		

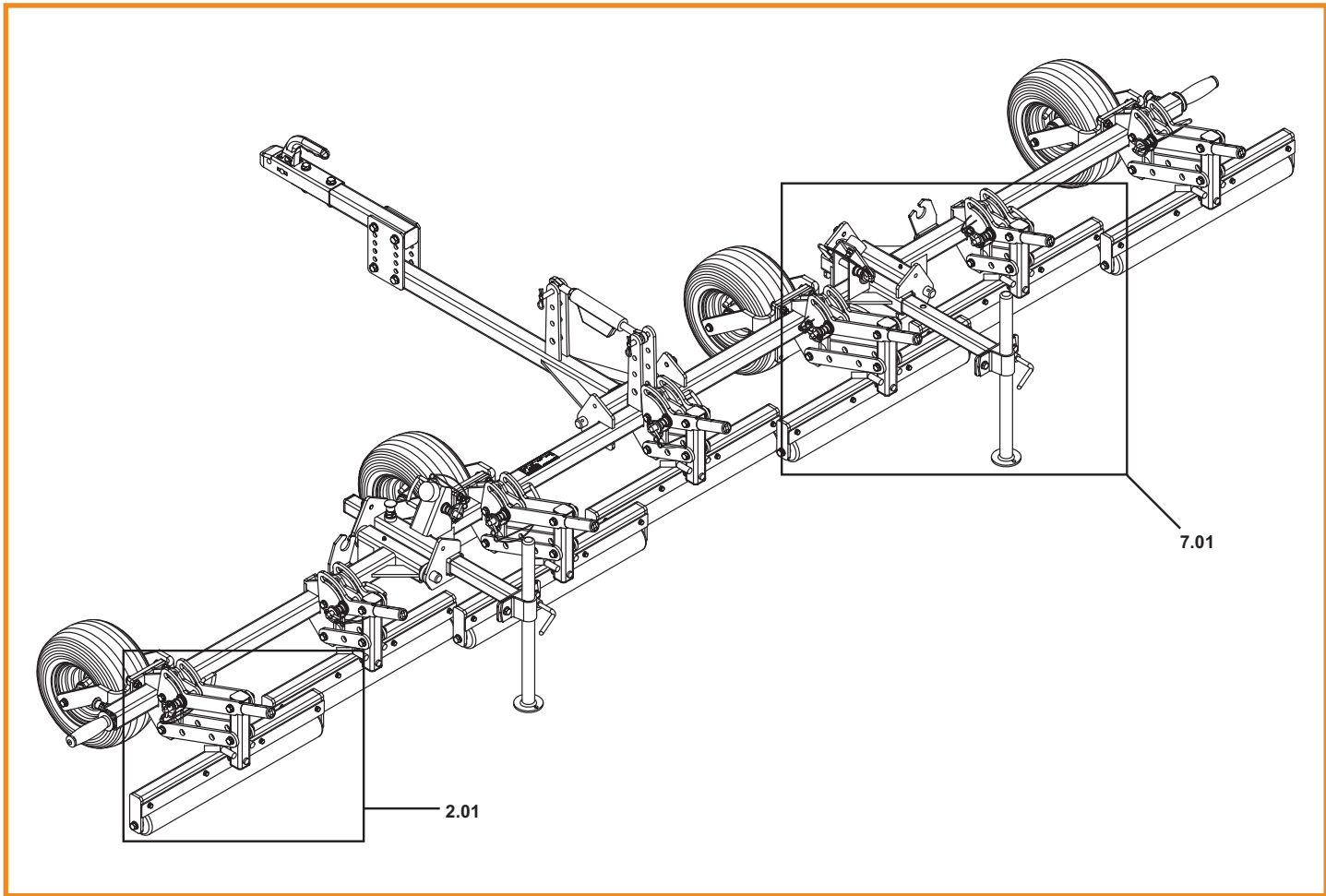

1.02

Flexi 400_2

Item No.	Part No.	Description	Quantity
2.01	See Page 10		
7.01	See Page 17		

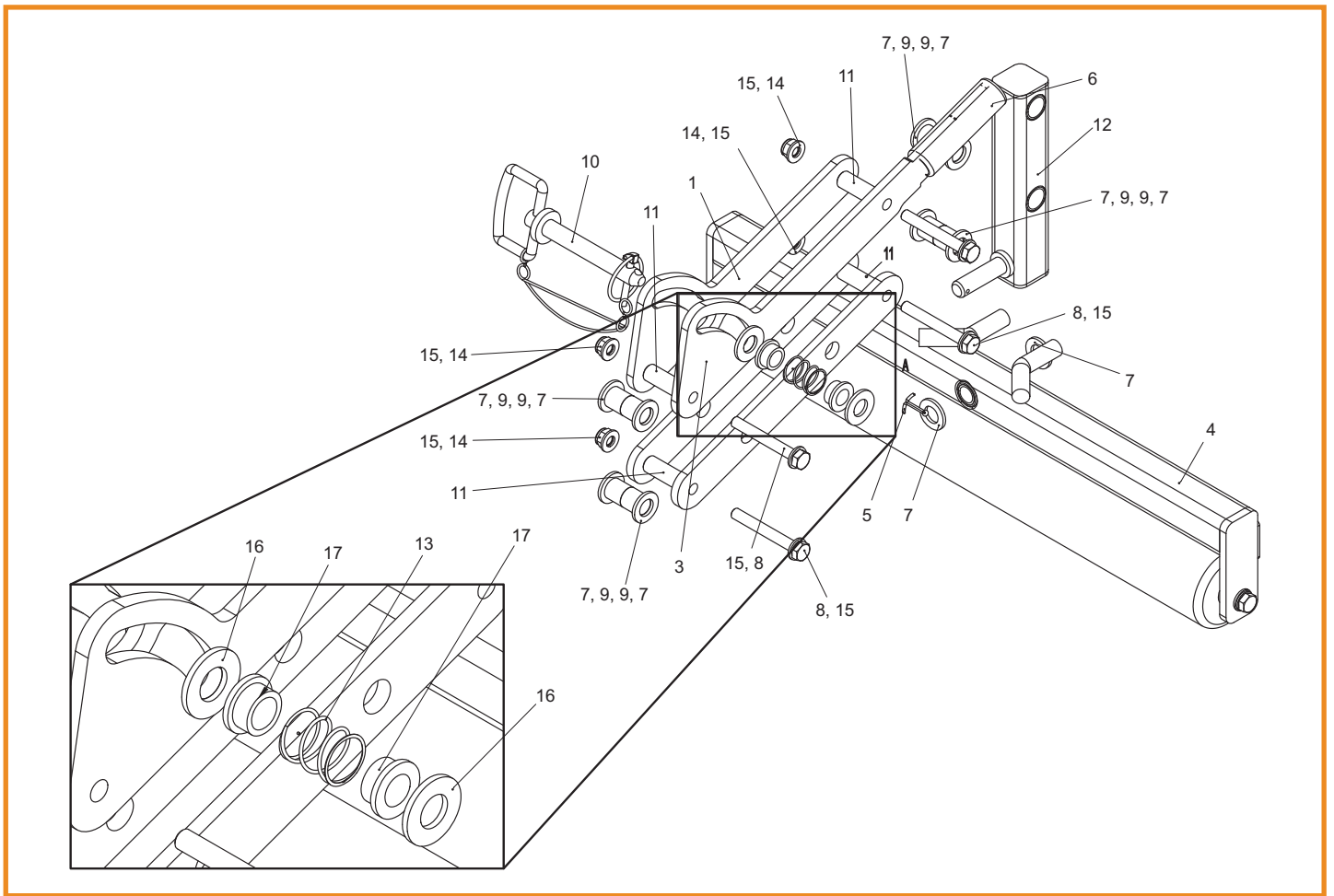

2.01

Roller Assembly

Item No.	Part No.	Description	Default Qty
1	310039	Lock Arm Long	1
2	310040	Lift Arm Long	1
3	403164	Link Arm	2
4	See 2.02	Roller Head 24"	1
4	See 2.03	Brush Head 24"	1
5	D1044	Split Pin 1/8" x 1 1/4"	1
6	D8256	Foam Handle Grip	1
7	E1-1080	Washer M16 Form A	10
8	E1-1134	Hex Set Screw M10 x 80	4
9	F20606	Bush AM1620 - 20	8
10	F21746	Hitch Pin 16Dia	1
11	F32461	Pivot Pin	4
12	F32463	Roller Pivot Bracket	1
13	J209246	Top Drive Spring	1
14	SP02008	Nut M10 Nyloc (T)	4
15	SP03011	Washer M10 Form A	8
16	SP03021	Washer M16 Form C	2
17	SP06024	Bush AL 1622-12	2

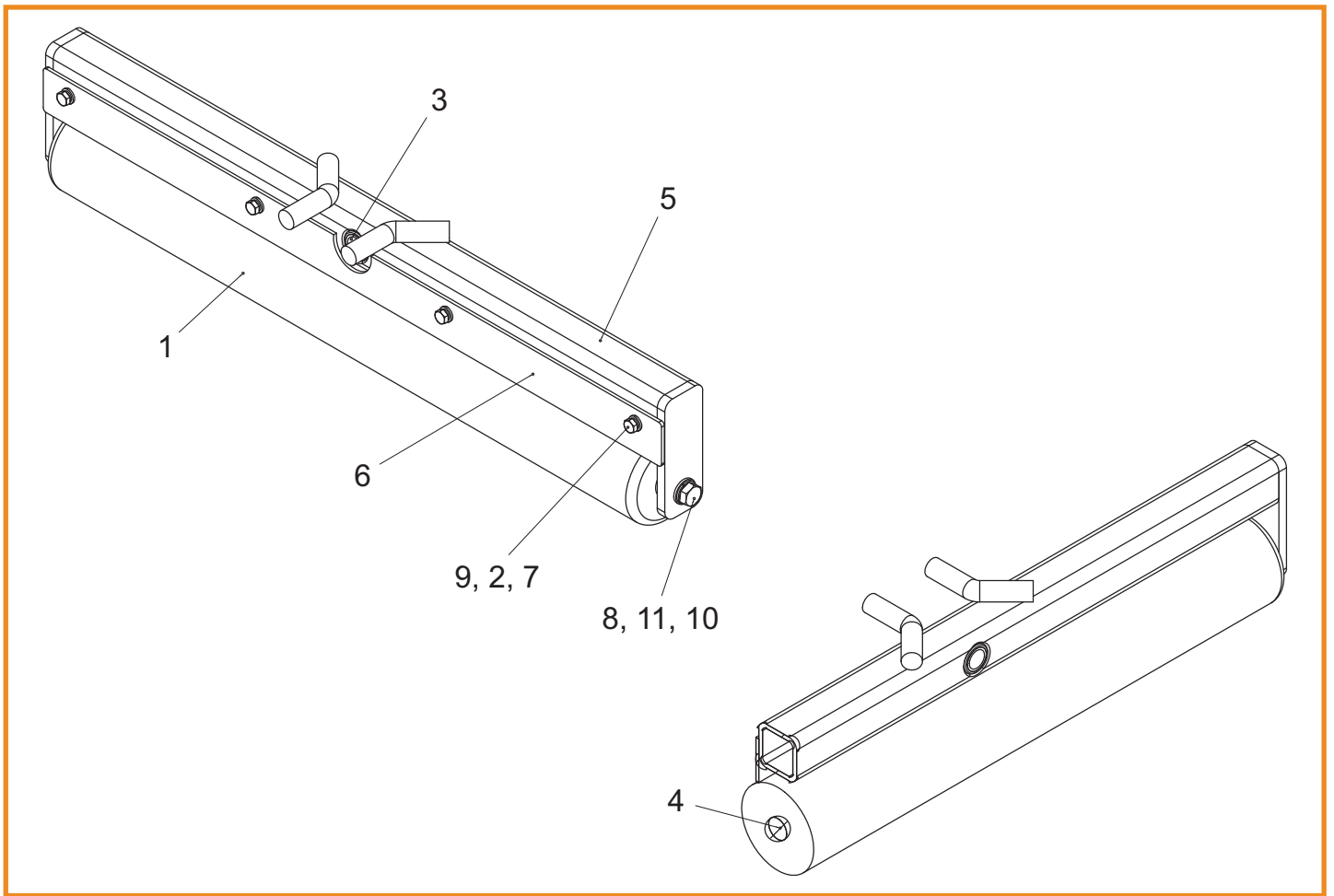

2.02

Roller Head 24'' (800227)

Item No.	Part No.	Description	Quantity
1	D7226	Roller	1
2	E1-1061	Washer M6 Spring	4
3	F20606	Bush AM1620 - 20	2
4	F32457	Roller Shaft	1
5	F32458	Roller Frame	1
6	F32464	Scraper Blade	1
7	SP01028	Hex Set Screw M6 x 20	4
8	SP01035	Hex Set Screw M10 x 25	2
9	SP03010	Washer M6 Form A	4
10	SP03011	Washer M10 Form A	2
11	SP03034	Washer M10 Spring Lock	2

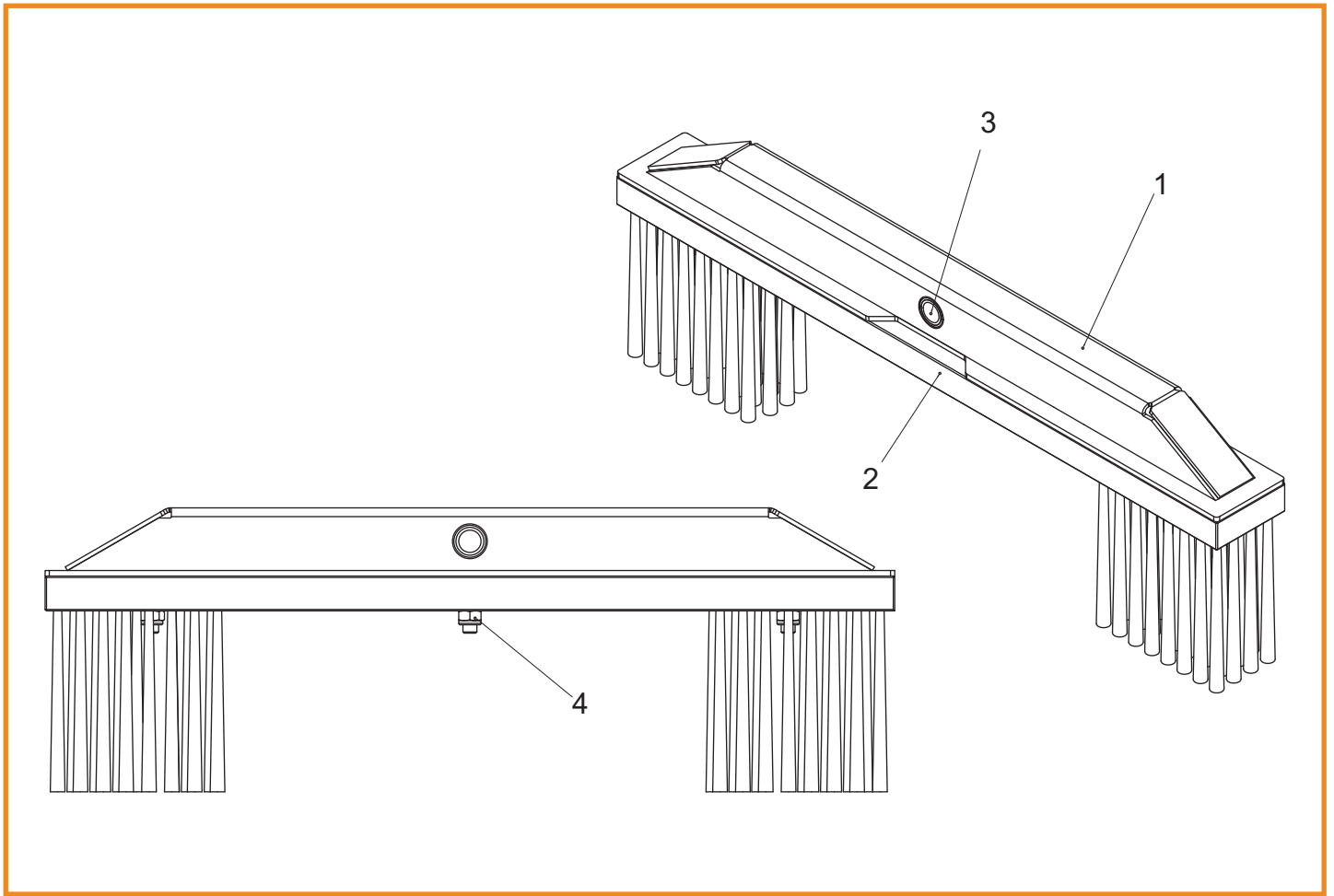

2.03

Brush Head 24" (800230)

Item No.	Part No.	Description	Quantity
1	310045	Brush Frame W.A.	1
2	D1520	Brush 24"	1
3	F20606	Bush AM1620 - 20	2
4	SP02008	Nut M10 Nyloc (T)	3

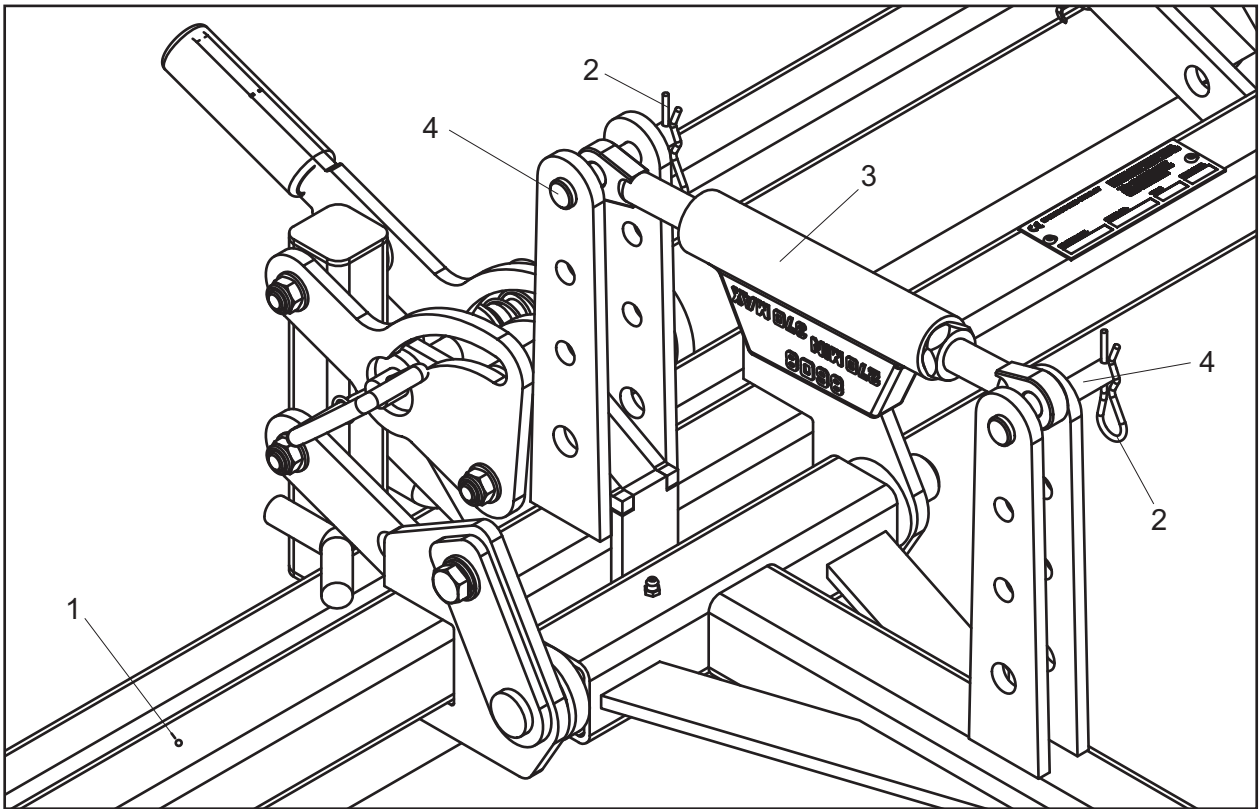

3.01

Item No.	Part No.	Description	Quantity
1	310001	Centre Frame	1
2	D1900	Clip R (Sparex Ref S9)	2
3	D8608	Turnbuckle Assembly	1
4	SP05021	Clevis Pin 1/2" x 3"	2

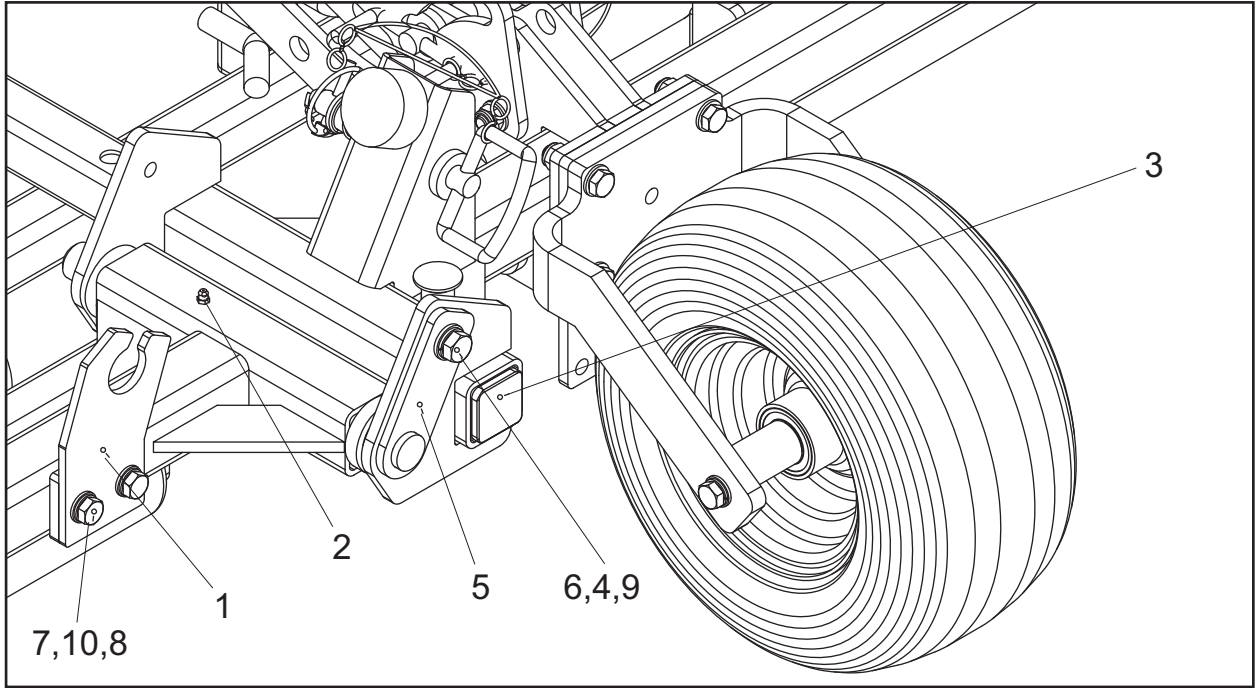

4.01

Item No.	Part No.	Description	Quantity
1	310022	Latch Plate	2
2	D1947	Grease Nipple M6	3
3	D8955	Tube Bung 40 x 40	2
4	E1-1065	Spring Washer M12 Sq Section	3
5	F36623	Pivot Pin	3
6	SP01021	Hex Set Screw M12 x 20	3
7	SP01034	Hex Set Screw M10 x 20	4
8	SP03011	Washer M10 Form A	110
9	SP03012	Washer M12 Form A	15
10	SP03034	Washer M10 Spring Lock	12

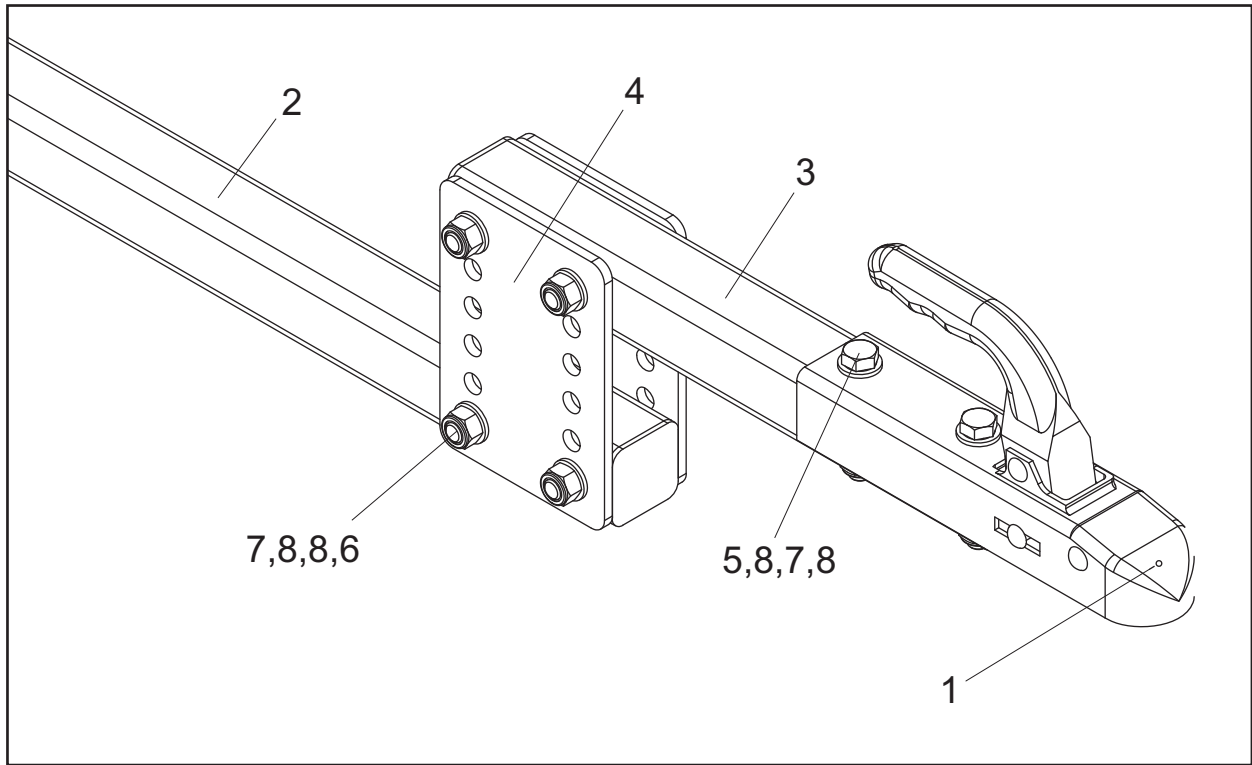

5.01

Item No.	Part No.	Description	Quantity
1	210772	Drawbar Coupling 50mm Ball	1
2	310025	Tow Arm Assy	1
3	310041	Hitch Bar Assy	1
4	310043	Towbar Plate	2
5	E1-1166	Hex Bolt M12 x 75	2
6	E1-1167	Hex Bolt M12 x 80	4
7	SP02010	Nut M12 Nyloc (T)	6
8	SP03012	Washer M12 Form A	15

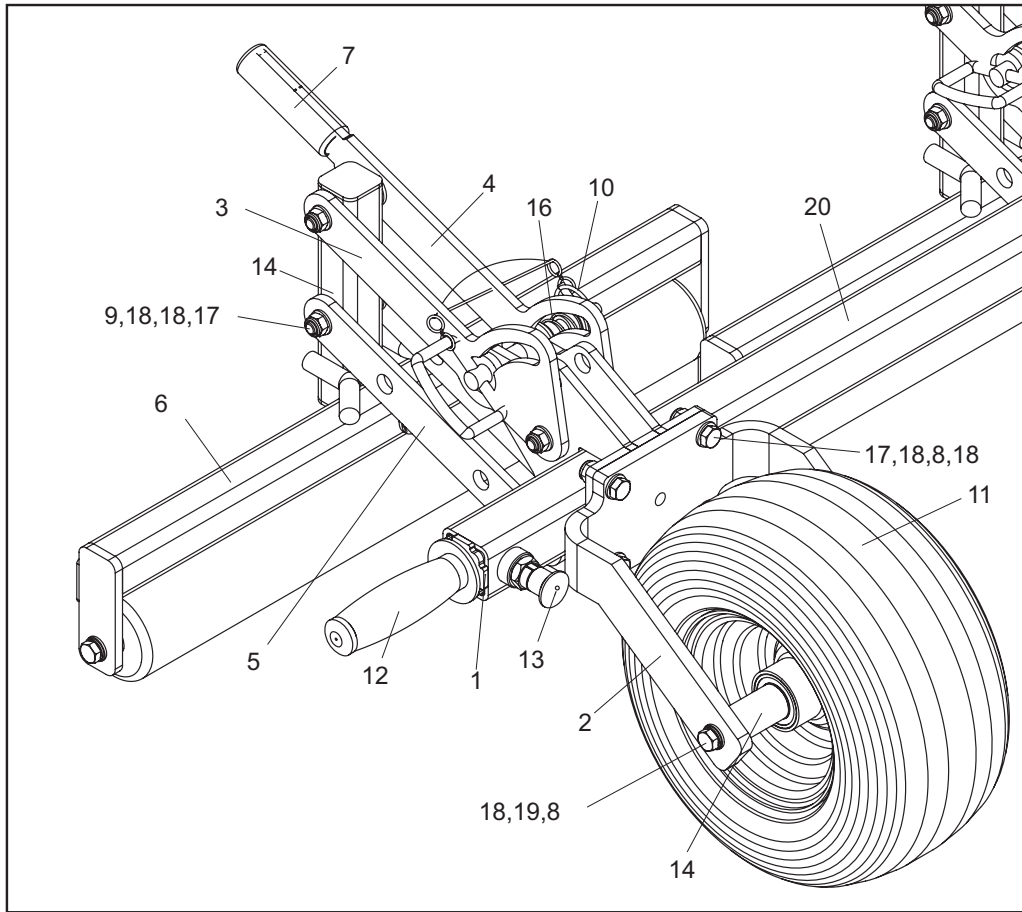

6.01

Item No.	Part No.	Description	Quantity
1	310011	Lever Assy	2
2	310021	Wheel Bracket	4
3	310039	Lock Arm Long	4
4	310040	Lift Arm Long	4
5	403164	Link Arm	8
6	See 2.02	Roller Head 24"	7
7	D8256	Foam Handle Grip	7
8	E1-1119	Hex Set Screw M10 x 35	16
9	E1-1134	Hex Set Screw M10 x 80	28
10	F21746	Hitch Pin 16Dia	9
11	F21940	Wheel , Tyre & Hub Cap	4
12	F22019	Handle Grip	2
13	F22336	Indexing Plunger	4
14	F32463	Roller Pivot Bracket	7
15	F36098	Spacer	4
16	J209246	Top Drive Spring	9
17	SP02008	Nut M10 Nyloc (T)	50
18	SP03011	Washer M10 Form A	110
19	SP03034	Washer M10 Spring Lock	12
20	310015	Roller L.H. Arm Assy	1

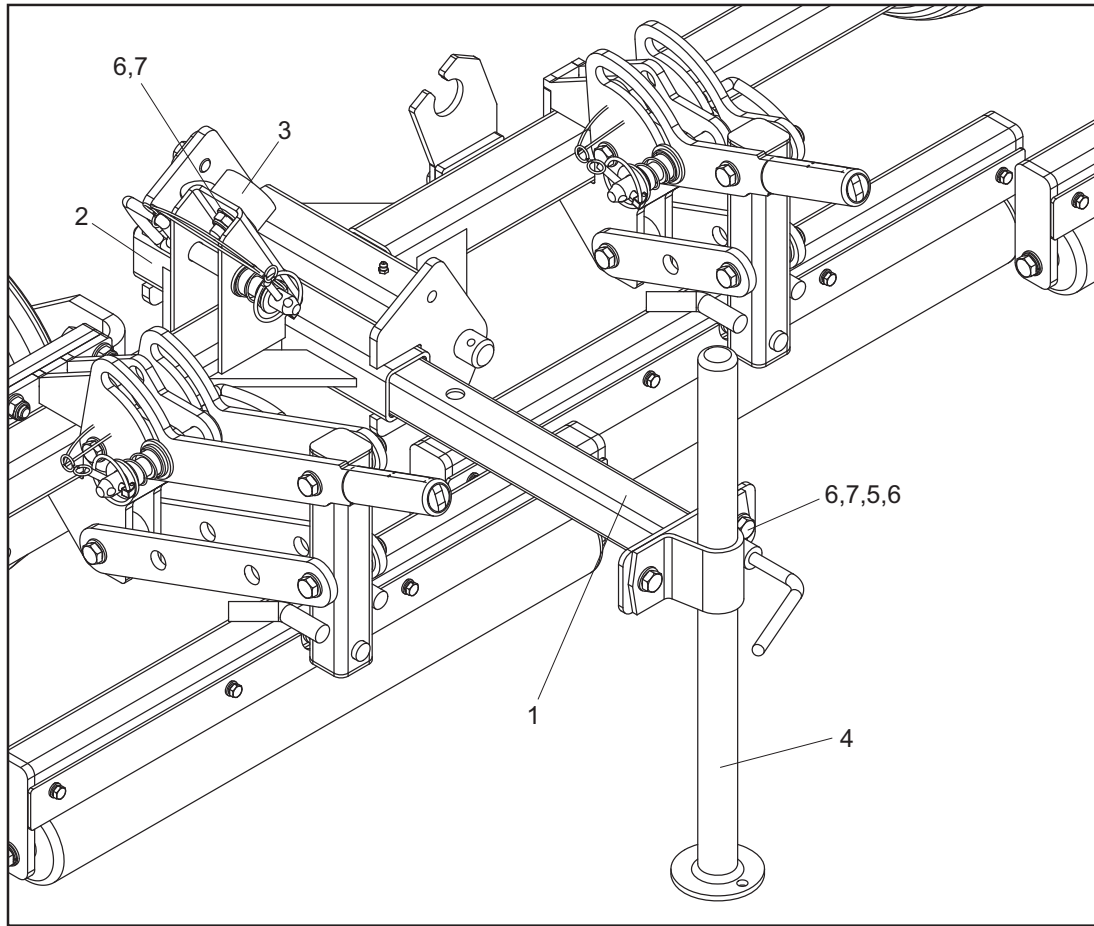

7.01

Item No.	Part No.	Description	Quantity
1	310030	Stand Assy	2
2	D8955	Tube Bung 40 x 40	2
3	F20080	Rubber Stop	2
4	F20723	Drop Leg Assembly 20"	2
5	SP01035	Hex Set Screw M10 x 25	4
6	SP02008	Nut M10 Nyloc (T)	50
7	SP03011	Washer M10 Form A	3

sisis®

SISIS, Ashbourne Road, Kirk Langley, Derbyshire, DE6 4NJ, England.

Tel: +44 (0) 1332 824 777 | Fax: +44 (0) 1332 824 525 | Email: info@sisis.com | www.sisis.com

A division of Howardson Ltd. - a proudly British company
Company reg no 641526 - Vat No GB 345 9918 12